



GPS L1 Inline Antenna Amplifier

KEY FEATURES

- Extend GPS Antenna Cable Length Up to 300 Feet (91 m)
- Fits in Line With the Antenna Cable
- No External Power Source Required
- Simple Installation

Cable length is a common source of signal loss between a GPS antenna and the receiver. As with any electromagnetic radio wave, GPS signals become attenuated as they are passed through electrical cable. The amount of signal loss depends on the type and length of the cable used. In some Symmetricom GPS receivers, when the antenna cable length exceeds 150 feet, signal strength can drop below the receiver's ability to track the

signal. The inline amplifier mitigates this problem by amplifying the GPS signal and permitting a longer antenna cable. The inline amplifier attaches directly in line with the antenna cable and uses the same power as the antenna; no extra wiring is required.



GPS L1 Inline Amplifier is a simple and elegant solution to extend the GPS antenna length to 300 feet (91 m).

GPS L1 Inline Antenna Amplifier Specifications

GENERAL INFORMATION

- Power: Input voltage is from 4 to 28 VDC. Current draw is 10 ma at 4 VDC, 20 ma at 28 VDC. Power to the inline amplifier is provided from the GPS receiver
- Size: 3.770 inches in length, 0.605 inches in diameter
- Gain: 20 ± 2.0 dB
- Noise: Noise figure is <3 dB
- Connectors: TNC type female, both ends
- Maximum cable length* 300 feet (91 m)

*Installation Requirements: The cable length extension is subject to the following requirements. Any deviation from these specifications may reduce the extended cable length.

- Belden 9104 cable
- No sharp bends in the cable between the antenna and the GPS receiver.
- There are a minimum number of connectors in the cable.
- Ideally only one unspliced cable on either side of the amplifier.
- The amplifier should be installed closer to the GPS antenna than to the GPS receiver. The amplifier can fit protected inside the mounting mast provided with the GPS antenna.
- Antenna cable runs in excess of 300 feet require the Symmetricom GPS Down/Up Converter in place of the inline amplifier described in this document.
- Symmetricom GPS equipped products come standard with 50 feet of cable. Longer lengths or additional cables may be purchased separately.

PRODUCT INCLUDES

- GPS L1 inline antenna amplifier, 3" adapter cable with TNC (f) terminations to connect amplifier to antenna



Inline Antenna Amplifier Kit

OPTIONS

- Extended Cable (200 ft./60 m)
- Extended Cable (250 ft./75 m)
- Extended Cable (275 ft./82.5 m)
- Extended Cable (300 ft./90 m)
- GPS L1 GPS Antenna Splitter
- GPS Lightning Arrestor Kit w/25 ft. (7.5 m) cable
- GPS Lightning Arrestor Kit w/50 ft. (15 m) cable

Part No.

340-200-5
340-250-5
340-275-5
340-300-5
150-711
150-709
150-710

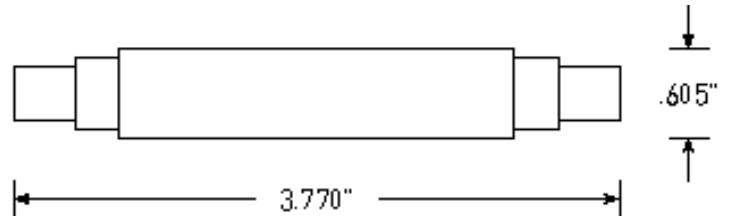
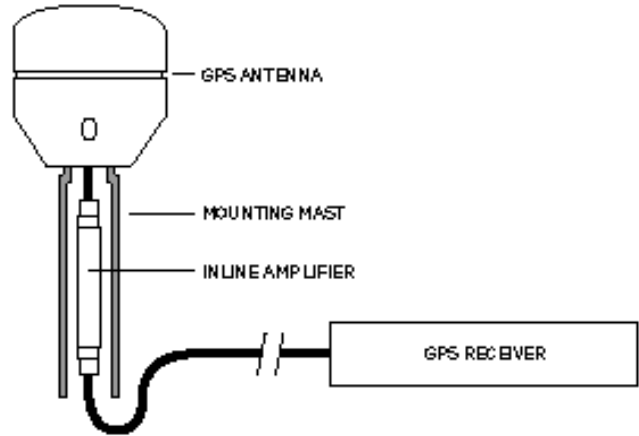

SYMMETRICOM, INC.
CORPORATE
2300 Orchard Parkway
San Jose, California
95131-1017
tel: 408.433.0910
fax: 408.428.7896
info@symmetricom.com
www.symmetricom.com